

# Boundary Dam

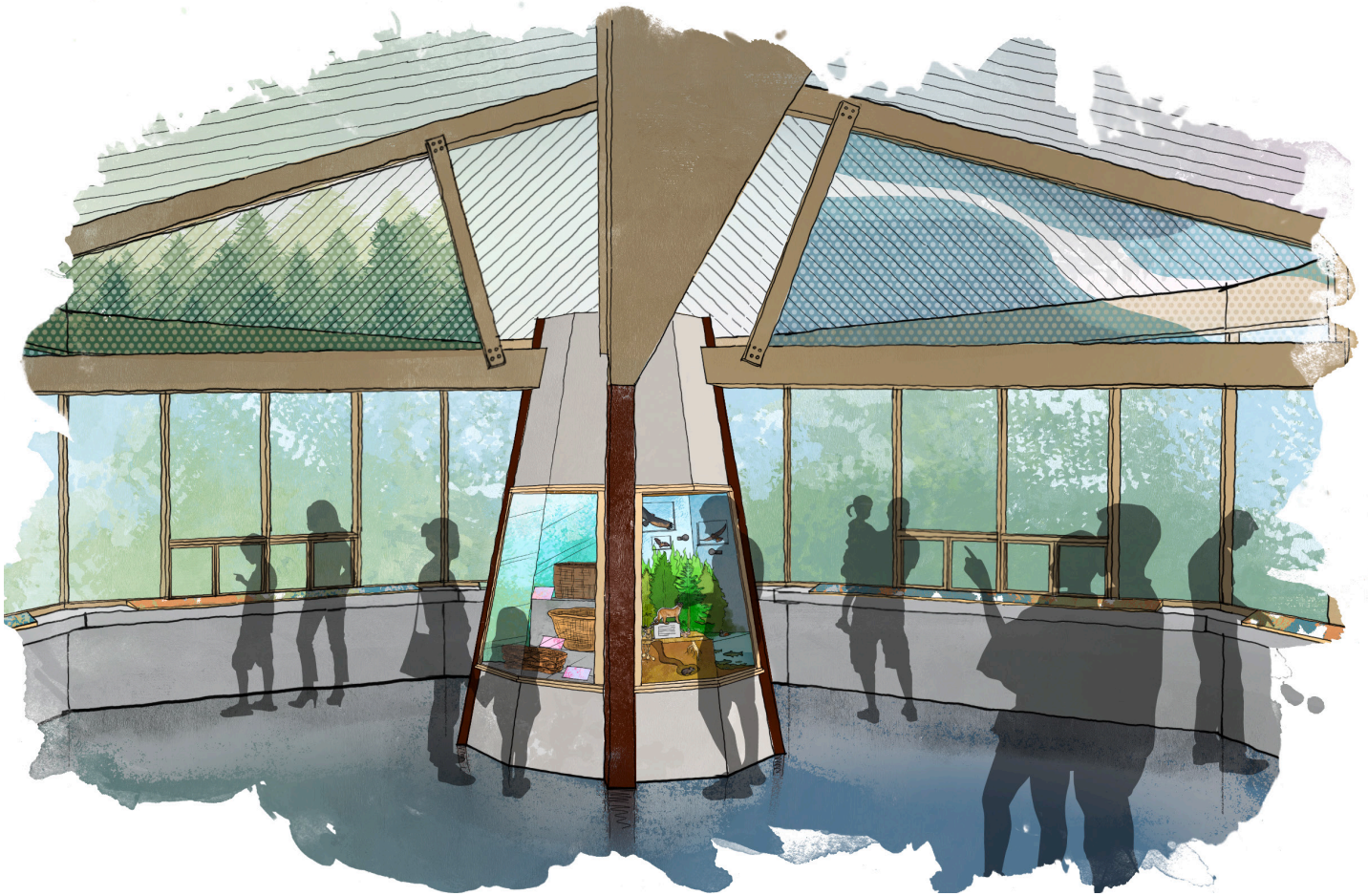

## Power and Play

The Boundary Hydroelectric Project in northeastern Washington provides electricity to Seattle, and recreational opportunities and facilities for visitors to this remote dam and reservoir. Seattle City Light, the electric utility company that owns and operates the project, wanted refreshed indoor and new outdoor interpretation to celebrate its feats of engineering, renewable energy production, and natural resources.

APA worked closely with Seattle City Light to tell a cohesive story across the project site. The Vista House, a component of the Boundary Project built in 1965 that provides near-panoramic views of Boundary Dam, will house interactive experiences, grounding visitors in the dam's construction and clean-energy production. Portage Park provides a trail around the falls, elevated viewpoints, and, now, informational signage for visitors. The salmonid hatchery will have a kiosk tying the important facility to both the watershed and visitors.

